

# DMT80600T121\_31W

12.1 Inches, 800xRGBx600, 16.7M Colors, Android LCM



### Record of Revision

Revise Date	Content
2014-09-26	First Edition

## ● Display

Item	Parameter	Description
Color	16.7M (16777216) colors	24-bit color 8R8G8B
Active Area (A.A.)	246.0mm (W) x184.5mm (H)	800x600
View Area (V.A.)	246.8mm (W) x186.0mm (H)	800x600
Resolution	800x600	
Backlight	LED	-
Brightness	500 nit (DMT80600T121_31WN)	64 levels adjustment
	450 nit (DMT80600T121_31WT)	64 levels adjustment

## ● Voltage & Current

Item	Conditions	Min	Typ.	Max	Unit
Power Voltage	Voltage jumper is ON	-	5.0	-	V
	Voltage jumper is OFF(Default)	6.0	12.0	42.0	V
Operation Current	VCC = +12V, Backlight on	-	1100	-	mA
Recommended power supply: 12V 2A DC					

## ● Reliability Test

Item	Conditions	Min	Typ.	Max	Unit
Working Temperature	60%RH at 12V voltage	-20	25	70	°C
Storage Temperature	-	-30	25	85	°C
Working Humidity	25°C	10%	60%	90%	RH
Protective Paint	-	-	None	-	-
Aging Test	-	-	24	-	H

## ● Interface

Item	Conditions	Min	Typ.	Max	Unit
Baudrate	Standard	1200	115200	921600	bps
	User define	1200	-	1000000	bps
Output Voltage (TXD, BUSY)	Output 1, Iout = 1mA	3.0	3.2	-	V
	Output 0, Iout = -1mA	-	0.1	0.2	V
Input Voltage (RXD, I/O)	Input 1, Iin = 1mA	2.0	3.3	15.0	V
	Input 0, Iin = -1mA	-15.0	0.0	0.3	V
Interface	Mode is determined by Jumper: ON = 8N1, 3.3V TTL/CMOS; OFF = 8N1, RS232				
Socket	8Pin_2.54mm				
USB	Yes (USB2.0, FAT32 file format)				
SD slot	Yes (FAT32 file format)				

## ● Peripherals

Peripherals Acquired	
Peripherals	DMT80600T121_31WN : WIFI, Ethernet, HDMI, Analog Video DMT80600T121_31WT : Resistive touch screen, WIFI, Ethernet, HDMI, Analog Video

## ● Packing Capacity & Dimension

Dimension				
Dimension	292.8 (W) x225.8 (H) x23.5 (N) / 32.8 (T)mm			
Net Weight	480g (DMT10768T097_31WN)			
	610g (DMT10768T097_31WT)			
Packing Capacity				
Model	Size	Layer	Quantity/Layer	Quantity(Pcs)
Carton1	220mm(L)x160mm(W)x47mm(H)	-	-	-
Carton2	250mm(L)x200mm(W)x80mm(H)	2	1	2
Carton3	320mm(L)x270mm(W)x80mm(H)	-	-	-
Carton4	450mm(L)x350mm(W)x300mm(H)	1	10	10
Carton5	600mm(L)x450mm(W)x300mm(H)	1	20	20

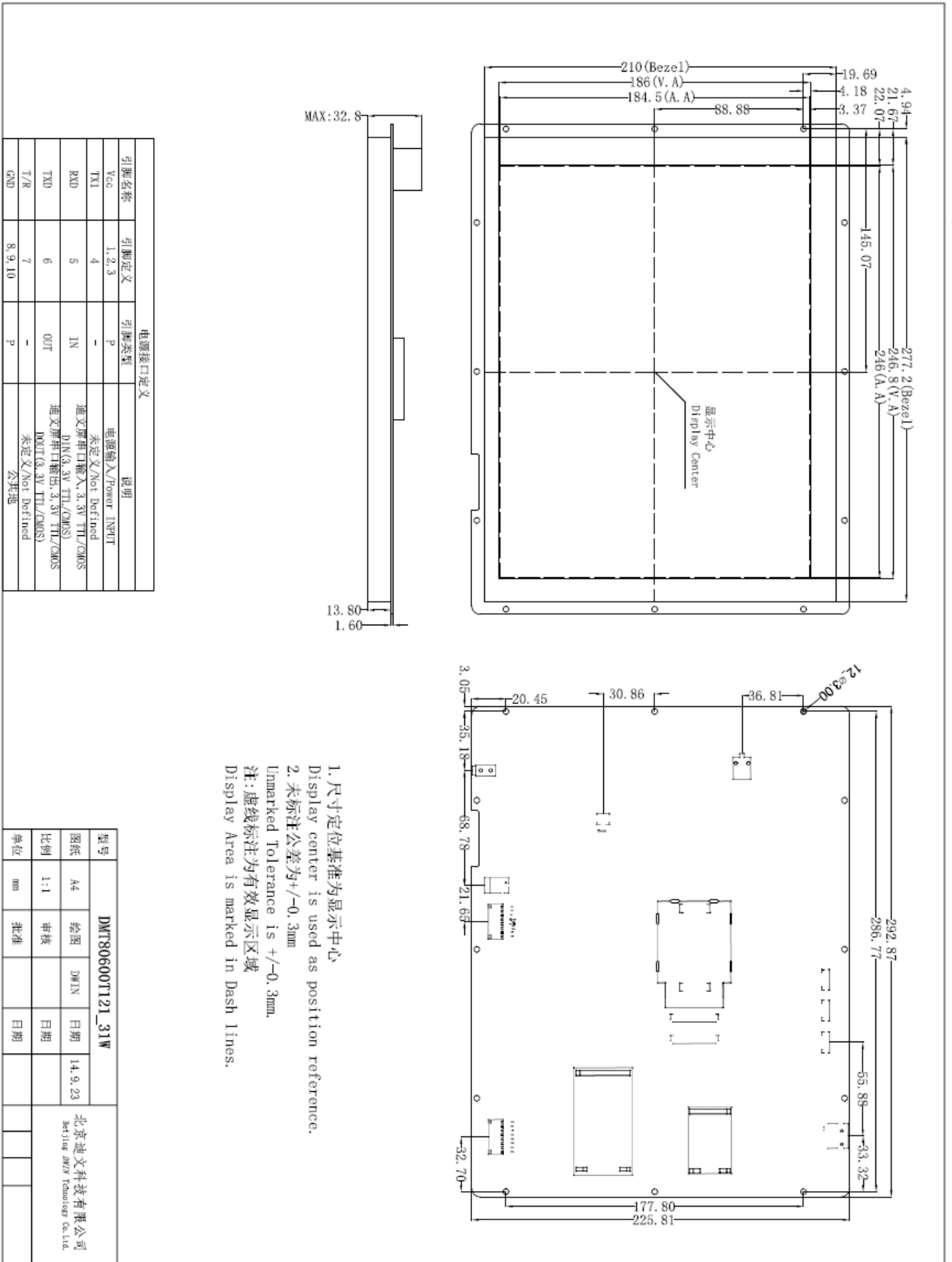

1. 尺寸定位基准为显示中心  
Display center is used as position reference.  
2. 未标注公差为 $\pm 0.3\text{mm}$   
Unmarked Tolerance is  $\pm 0.3\text{mm}$ .  
注: 虚线标注为有效显示区域  
Display Area is marked in Dash lines.